

TOWN OF ELMORE, VT

Monthly Select Board Meeting

Meeting Minutes – prepared by G. Schwartz
Status: Approved

Meeting Date: February 10, 2021

Start Time: 6:05 pm **Adjourn:** 7:20 pm

Meeting Attendees via electronic means: Caroline DeVore, Robb Wills, Glenn Schwartz, Michel LaCasse, Don Valentine, Laura Stone, Jim Cota, Jon Olin, Robert Moore, Sheila Rysz and Kristen Rose

This meeting was conducted remotely via electronic means

Meeting Minutes Approval:

The minutes of the January 13, 2020 Select Board Meetings were approved

1. SPECIAL TOPICS:

- a. **Information:** Regional Concerns Meeting for Bridges 90 and 94 (Laura Stone)

Bridge replacement projects to be reviewed:

Elmore STP CULV(64) – VT Route 12, Bridge 90 over unnamed brook

<https://outside.vermont.gov/agency/vtrans/external/Projects/Structures/18B003>

Elmore BF 0241(55) – VT Route 12, Bridge 94 over unnamed brook

<https://outside.vermont.gov/agency/vtrans/external/Projects/Structures/19B212>

Notes:

- Laura Stone from The Vermont Agency of Transportation presented information, regarding two culverts on Route 12 in Elmore that will be replaced in the 2024/2025 construction season. These structures are currently in the design stage. A copy of the presentation is attached to these minutes.
- G. Schwartz to Contact Kent Shaw to post construction information on the Elmore Website.

2. ACTIVE ITEMS:

- b. **UPDATE:** Town Meeting Day and information meeting

Notes: Information Meeting will be held on February 23, 2021. The Town is waiting on delivery of ballots and the will be sent out ASAP. Elmore Town Reports are ready for pick up at the Elmore Store, Elmore Town Office and available to preview on the Town Website at www.elmorevt.org. Town Reports will only be mailed out by request. You can call the Elmore Town Office at 888-2637 or email sdraper@elmorevt.org

TOWN OF ELMORE, VT

Monthly Select Board Meeting

- c. **UPDATE:** Elmore Highway Maintenance Facility

Notes:

- R. Wills has been meeting with B. Burley regarding the Elmore Highway Maintenance Facility
- A presentation and update will be made at the informational meeting on February 23, 2021.

- d. **UPDATE:** Estimate for Clerk's office maintenance

Notes: R. Wills has contacted Brian Baker and Marino Painting for proposals and pricing to perform the following Town Office maintenance;

- Soffit and fascia repairs
- Pressure wash vinyl siding
- Screen Repairs
- Paint Windows trim, fascia and trim
- Install 2nd door

3. CONTINUING ACTIVE ITEMS: (Update status by principle owner):

- a. **UPDATE:** Road Commissioner's Report – Lacasse

Notes: The Road Commissioner reported the following;

- Plow truck breakdown was repaired within one week
- Plowing and sanding operations as required

- b. **CONTINUING:** Elmore Town Office Closures: Remain in effect. All person's wishing to conduct business in the Town Clerk's Office or with the Board of Listers must make an appointment. During appointments, all visitors must wear a mask to cover their nose and mouth. Office employees must practice social distancing of 6 feet. If social distancing cannot be practiced, masks must be worn.

Notes: The Select Board Meeting will continue to be conducted remotely via Zoom until further notice.

4. COMPLETED/INACTIVE ITEMS: (Update status by principle owner)

- a. Review Action Item List

Notes: The action list was not reviewed at this meeting

TOWN OF ELMORE, VT
Monthly Select Board Meeting

5. NON AGENDA/OTHER ITEMS: (Time Available)

- a. **DISCUSSION:** Check Warrant Report

Notes: The Check Warrant Reports that were supplied by S. Draper were reviewed and accepted by the Select Board. G. Schwartz to sign for the Board.

6. EXECUTIVE OR DELIBERATIVE SESSION AS NEEDED

- The Select Board entered into executive Session at 7:20 pm



WE12 - Worcester Elmore VT Route 12 Public Informational Meeting

VT Route 12 – Elmore Bridges #90 & 94

February 10, 2021

Introductions

Laura Stone, P.E.

VTrans Consultant Project Manager

Jon Olin, P.E.

Hoyle Tanner Project Manager

Purpose of Meeting

- Provide an understanding of our approach to the project
- Provide an overview of project constraints
- Discuss our selected alternative
- Provide an opportunity to ask questions and voice concerns

Meeting Overview

- VTrans Project Development Process
- Project Overview
 - Existing Conditions
 - Alternatives Considered
 - Selected Alternative
- Maintenance of Traffic
- Schedule
- Summary
- Questions

VTrans Project Development Process



Location Map

- ELMORE BF 0241(55) 19B212, VT Route 12, Bridge 94 over unnamed brook.
- ELMORE STP CULV(64) 18B003, VT Route 12, Bridge 90 over unnamed brook.
- WORCESTER BF 0241(56) 19B213, VT Route 12, Bridge 87 over Hardwood brook.
- WORCESTER BF 0241(57) 19B214, VT Route 12, Bridge 89 over North brook.
- WORCESTER BF 0241(59) 86E053, VT Route 12, Bridge 84 over the north branch of Winooski river

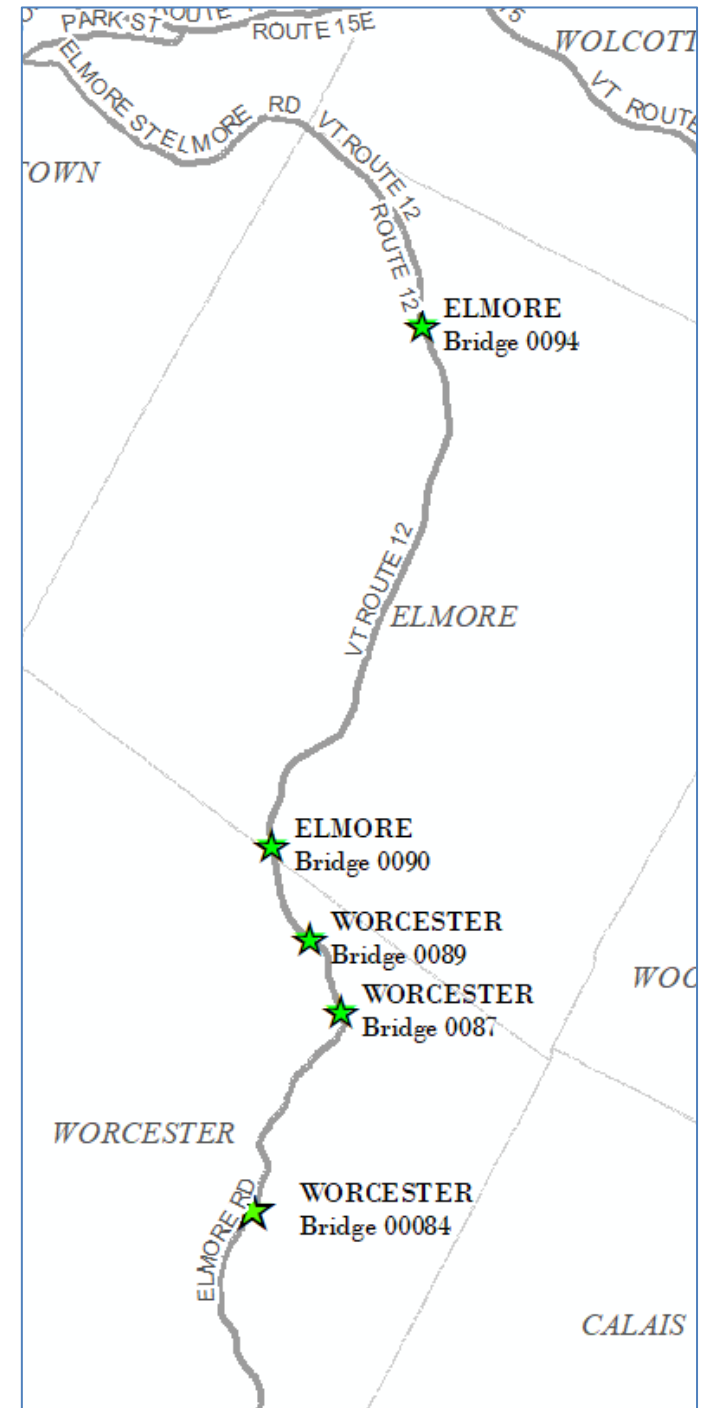

Design Criteria and Considerations

- Average Daily Traffic
 - 1,200 vehicles per day (Bridge 90)
 - 1,800 vehicles per day (Bridge 94)
- Design Hourly Volume
 - 180 vehicles per hour (Bridge 90)
 - 270 vehicles per hour (Bridge 94)
- % Trucks
 - 7.0% (Bridge 90)
 - 7.2% (Bridge 94)



Elmore STP CULV(64)

VT Route 12– Bridge #90 over Unnamed Brook



Bridge 90
Project Location

Looking North over Bridge 90



Existing Conditions – Bridge #90

- Roadway Classification – Major Collector
- Bridge Type – 6' Span CGMPP (Corrugated Galvanized Metal Plate Pipe)
- Culvert Length – 208 feet
- Fill Over Culvert – 18 feet
- Ownership – State of Vermont
- Constructed in 1964

Looking South over Bridge 90



Existing Conditions – Bridge #90

- Steep slopes upstream and downstream
- Exposed Bedrock

Existing Conditions – Bridge #90

- The culvert is in serious condition.
 - There is heavy rust scaling and holes throughout the invert.
 - The pipe has buckled under the roadway and cracks have formed.
- The existing culvert does not meet the calculated or measured bank full width (23') and does not meet the minimum hydraulic standard.

Condition Ratings

Existing Conditions - Bridge #90

- Culvert Rating 3 (Serious)

Inlet



Existing Conditions - Bridge #90

Outlet



Existing Conditions - Bridge #90

Barrel



Existing Conditions - Bridge #90

Resources – Looking Upstream



Existing Conditions – Bridge #90

- Northern Long-Eared Bat
- Wetlands
- Statewide significant agricultural soils and prime agricultural soils
- Wildlife Habitat

Existing Conditions

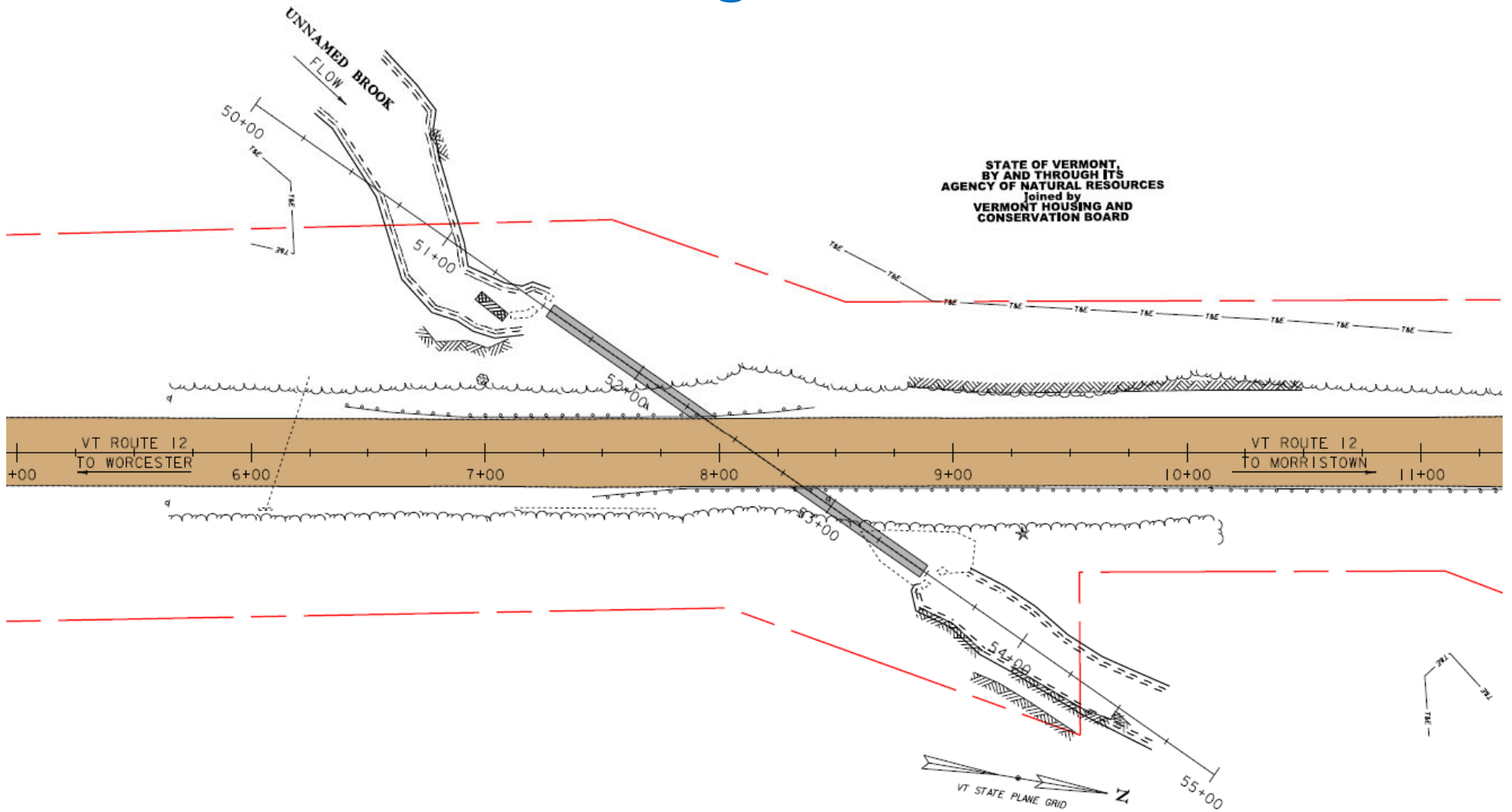

Alternatives Considered – Bridge #90

- No Action
 - Additional maintenance required within 10 years
- New Precast 3-Sided Frame
 - 23' x 6' waterway opening
 - 11'¼' typical
 - Expensive due to the amount of fill, skew, and length of frame needed
 - 75-year design life
- New Bridge
 - Approximate 60 to 80-foot Span (contingent on borings)
 - 11'¼' typical
 - Increased future maintenance costs
 - 75-year design life

Selected Alternative - Bridge #90

- Culvert Replacement with a New Bridge and One Lane Alternating Traffic Maintained on a Temporary Bridge
 - Substructure contingent on borings
 - Approximate 60' to 80' Span
 - 11'¼' typical to match existing conditions
 - Exceeds the 11'⅓' standard typical section
 - 75-year design life
 - Right of Way needed for temporary bridge and slope limits

Proposed Typical Section

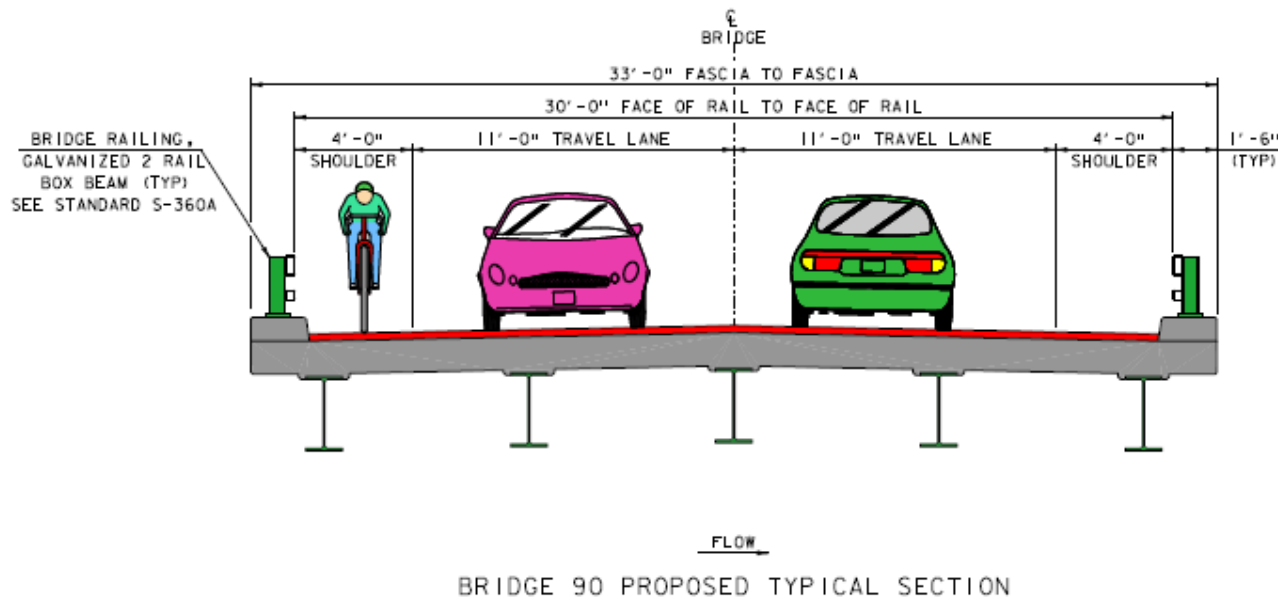
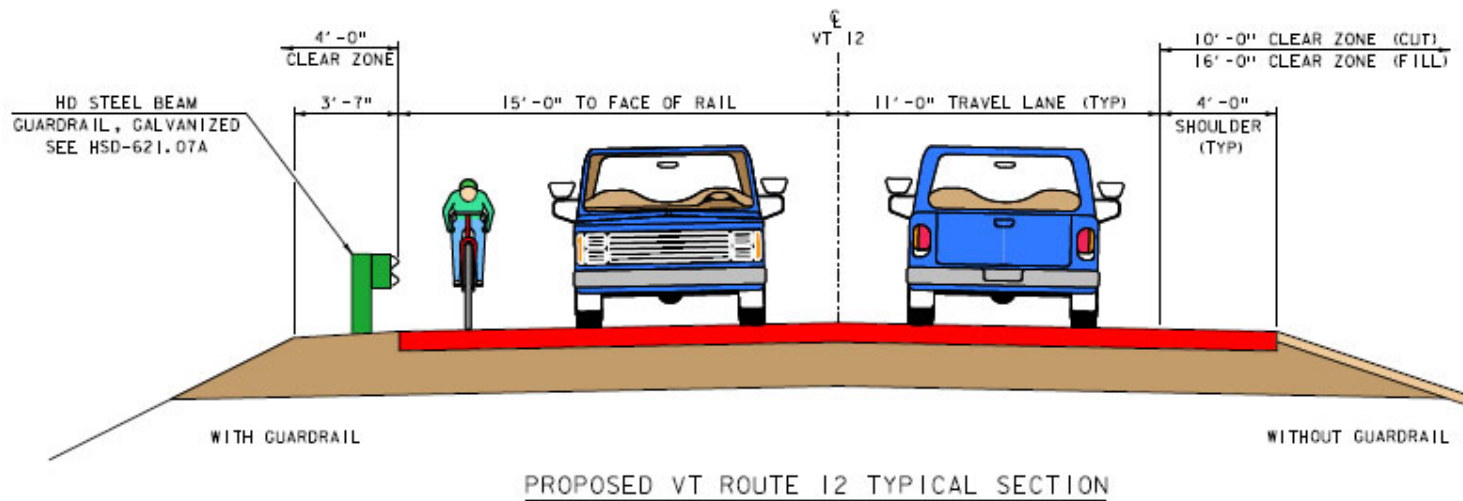

Slide 21

SL1

Stone, Laura, 2/4/2021

Proposed Layout

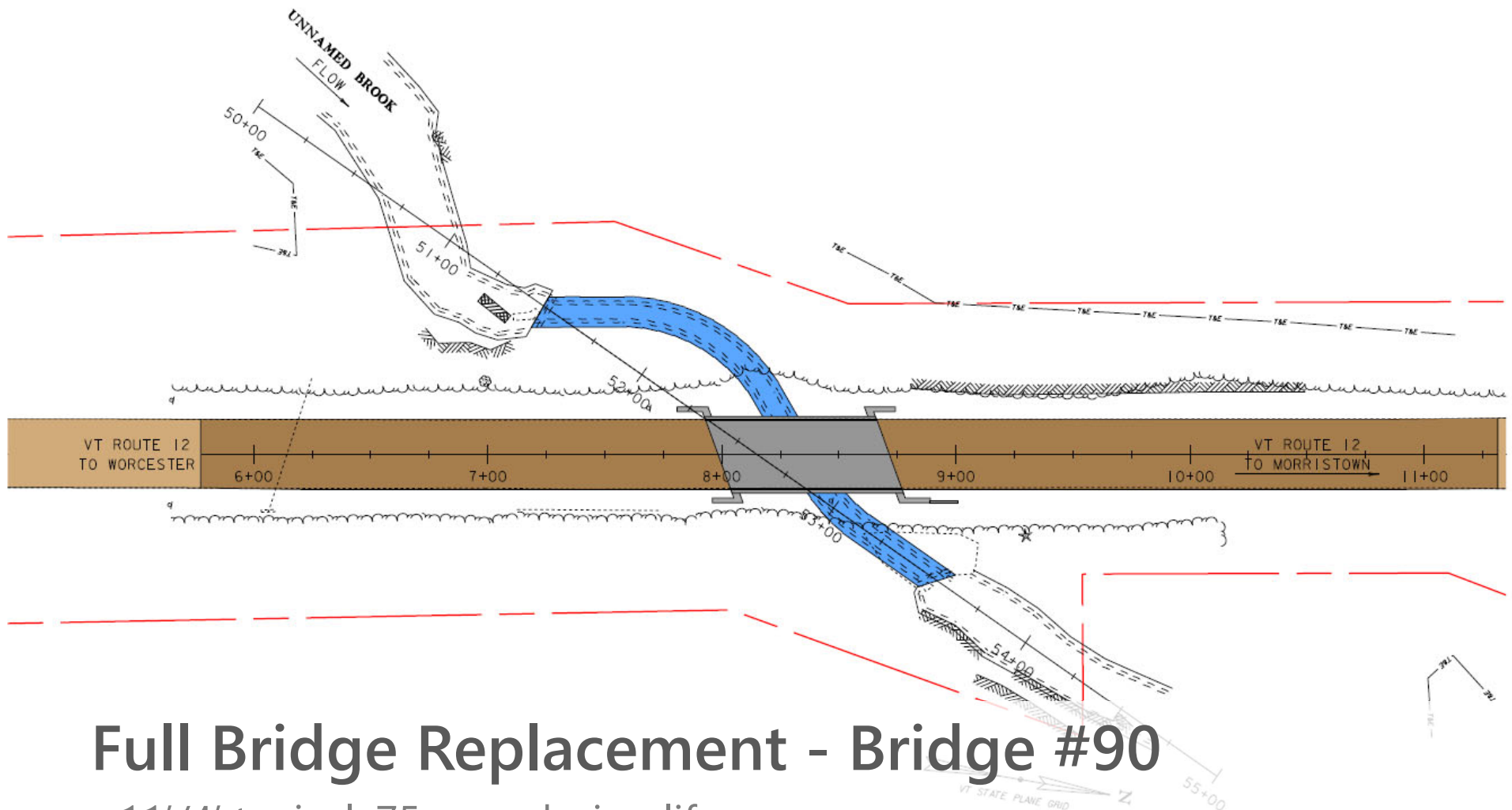

Full Bridge Replacement - Bridge #90

- 11'¼' typical, 75-year design life
- Approximate 60' to 80' Span
- Stream to be re-established back to natural state

Proposed Profile

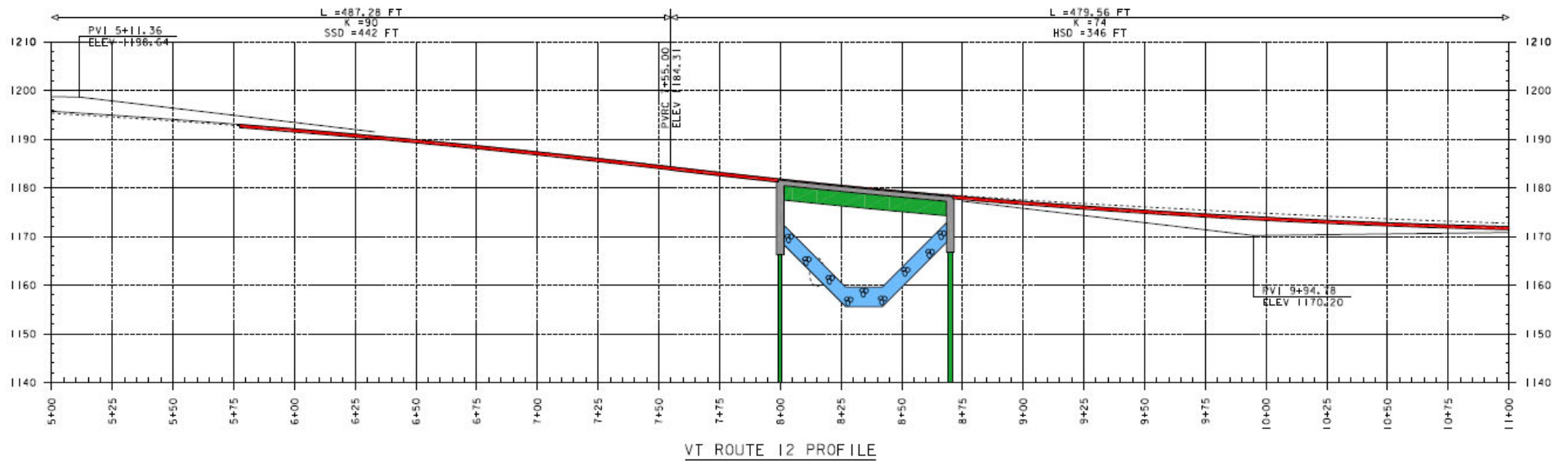

New Bridge - Bridge #90

- Match existing vertical grade
- Improved wildlife crossing

Maintenance of Traffic Options Considered

- Offsite Detour
- Phased Construction
- Temporary Bridge

Selected Method of Traffic Maintenance



Temporary Bridge

- One Lane Temporary Bridge constructed on Downstream side of VT Route 12

Downstream Temporary Bridge Layout

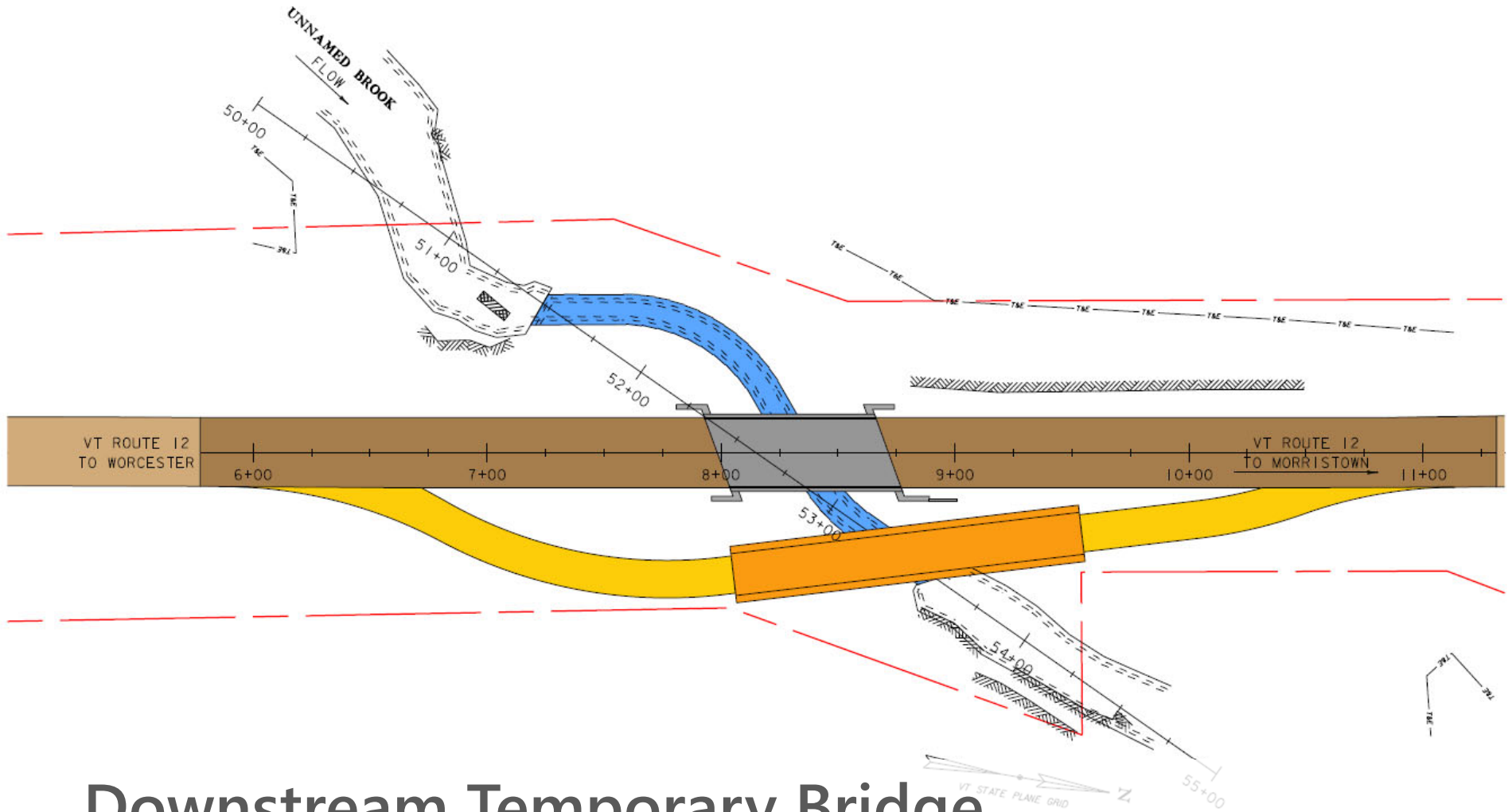

Downstream Temporary Bridge

- Potential limits outside the Right-of-Way
- Avoids ledge outcrop in NW quadrant

Preliminary Project Schedule

- Construction Start – Summer 2024
 - Total Cost Estimate: \$2,700,000

Project Summary: Bridge 90

- Culvert Replacement with a New Bridge and Traffic Maintained on a Downstream Temporary Bridge
 - Substructure type contingent on borings
 - Approximate 60' to 80' Span
 - 11'¼' typical to match existing conditions
 - Exceeds the 11'⅓' standard typical section
 - 75-year design life
 - Right of Way potentially needed for temporary bridge and slope limits

For more information:

- <https://outside.vermont.gov/agency/vtrans/external/Projects/Structures/18B003>



Elmore STP CULV(64) Questions and Comments VT Route 12– Bridge #90 over Unnamed Brook



Elmore BF 0241(55)

VT Route 12– Bridge #94 over Unnamed Brook



Bridge 94
Project Location

Google

Looking North over Bridge 94



Existing Conditions – Bridge #94

- Roadway Classification – Major Collector
- Bridge Type – 6' Span ACCGMPP (Aluminum Coated Corrugated Galvanized Metal Plate Pipe)
- Culvert Length – 74 feet
- Fill Over Culvert – 10 feet
- Ownership – State of Vermont
- Constructed in 1959

Looking South over Bridge 94



Existing Conditions – Bridge #94

- Aerial Utilities

Existing Conditions – Bridge #94

- The culvert is in fair condition.
 - There are holes throughout the invert up to 2-inches in diameter.
 - The asphalt coating is wearing off.
 - The outlet of the pipe has moved up causing some deflection in the culvert.
- The vertical alignment along VT Route 12 through the project area has a slightly substandard sag curve.
- The existing culvert does not meet the calculated or measured bank full width (11').

Condition Ratings



Existing Conditions - Bridge #94

■ Culvert Rating

5 (Fair)

Inlet



Existing Conditions - Bridge #94

Outlet



Existing Conditions - Bridge #94

Scour Hole Above Culvert



Existing Conditions - Bridge #94

Resources – Looking Upstream



Existing Conditions – Bridge #94

- Northern Long-Eared Bat
- Wetlands
- Archaeological Resources
- Primary agricultural soils
- Wildlife Habitat
- Scour along banks

Existing Conditions

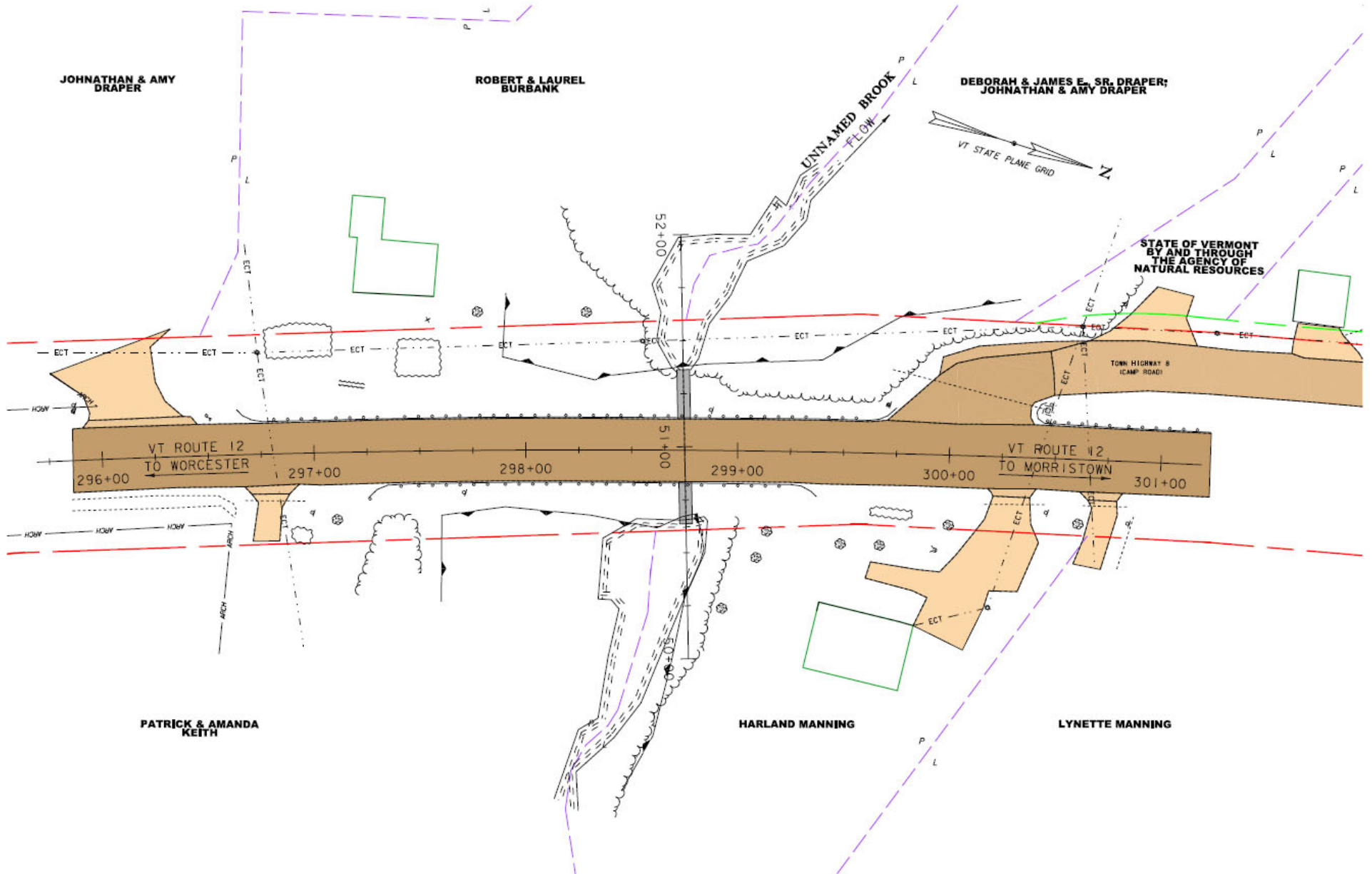

Local Concerns

- Four to Five residences are within 0.1 mile on VT Route 12 and Camp Road to Bridge 94. The culvert location is immediately adjacent to Camp Road with ANR Lake Access and seasonal and permanent residences along the eastern and southern shore of Lake Elmore. There are no suitable detour routes or local bypass routes available. VT Route 12 is the major morning and evening commuter road, including use by commercial vehicles and school busses.
- VT Route 12 through the project area is a summer bicycle tour route. This route is a renowned bicycle route for solo, group and tour rides, as well as occasional roller skiers particularly in spring, summer, and autumn. No suitable detour route for bicycles exists.
- Seasonal farm access to hay fields will be required, including large scale fertilizer vehicle traffic.
- There is an ANR Access area immediately adjacent to the project area.
- Bicycle and Pedestrian Traffic should be accommodated during construction.
- Approaches to construction site are somewhat blind as culvert is located in a depression obscured by knolls and a curve.

Alternatives Considered – Bridge #94

- No Action
 - Additional maintenance required within 10 years
- Culvert Rehabilitation
 - Invert Repair, Slip Liner, or Spray-on Liner
 - Further reduces substandard BFW – not ideal for wildlife crossing potential
 - 11’/4’ typical
 - 20 to 40-year design life
- New Precast 3-Sided Frame or Box Culvert
 - 11’ x 6’ waterway opening meets minimum BFW requirements
 - 11’/4’ typical
 - 75-year design life
- New Integral Abutment Bridge
 - Approximate 35-foot Span
 - 11’/4’ typical
 - Increased future maintenance costs
 - 75-year design life

Selected Alternative - Bridge #94

- Culvert Replacement with a New Buried Structure
 - Precast Concrete Box
 - Contingent on borings
 - 11' x 10' box with Type E4 Stone
 - 11' x 6' waterway opening
 - 75' Culvert Length
 - 11'¼' typical to match existing conditions
 - Exceeds the 11'⅓' standard typical section
 - 75-year design life

Proposed Typical Section

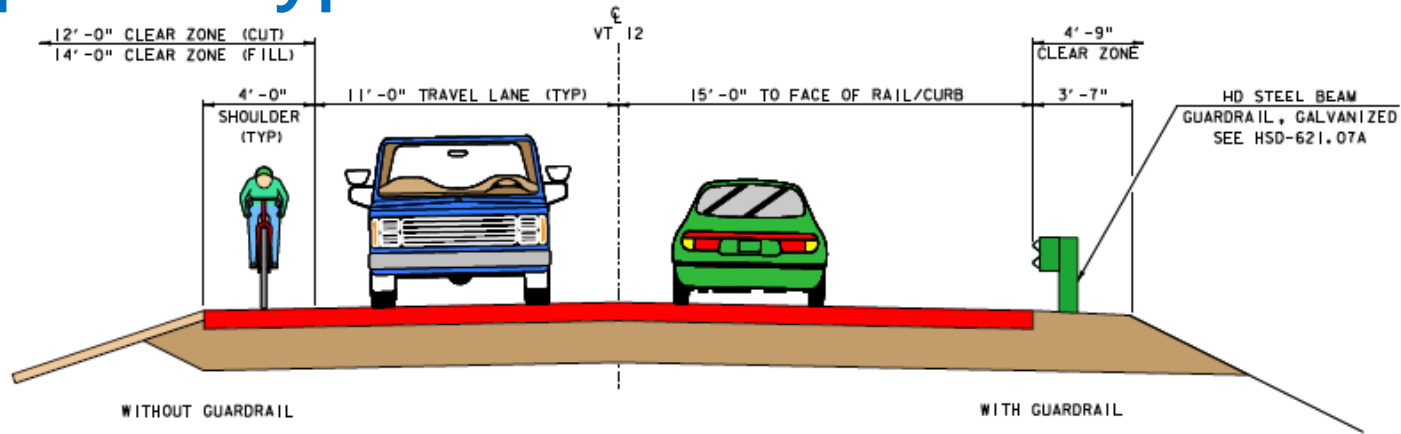

PROPOSED VT ROUTE 12 TYPICAL SECTION

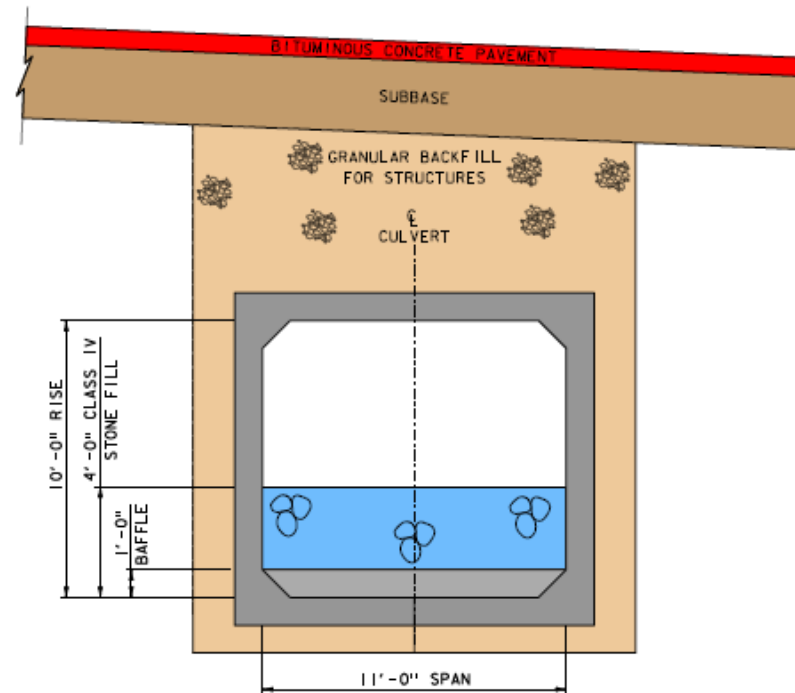

CULVERT 90 TYPICAL SECTION

Proposed Layout

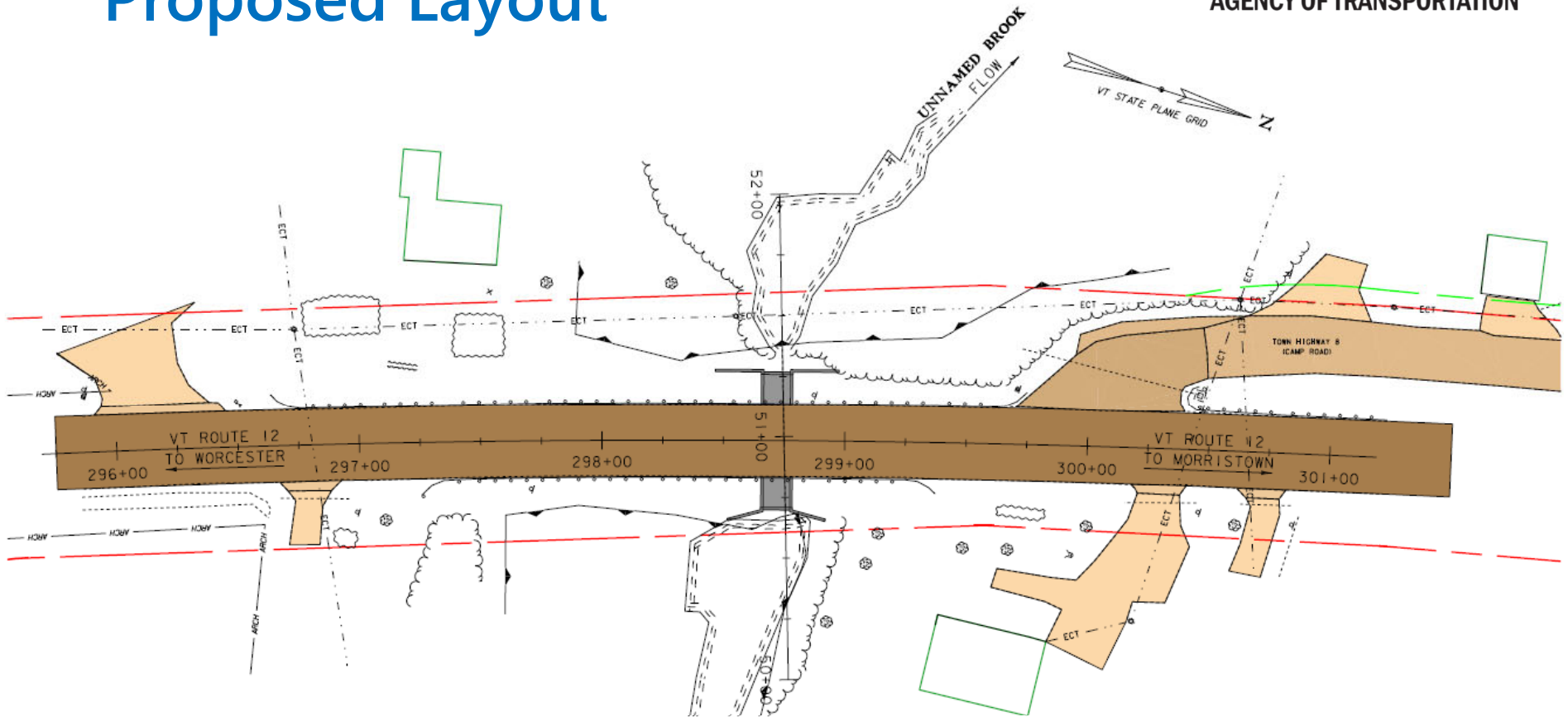

New Buried Structure, Frame or Box - Bridge #94

- 11¹/₄' typical, 75-year design life
- 11' x 6' waterway opening
- 75' Culvert Length
- ROW likely needed for inlet work in stream

Proposed Profile

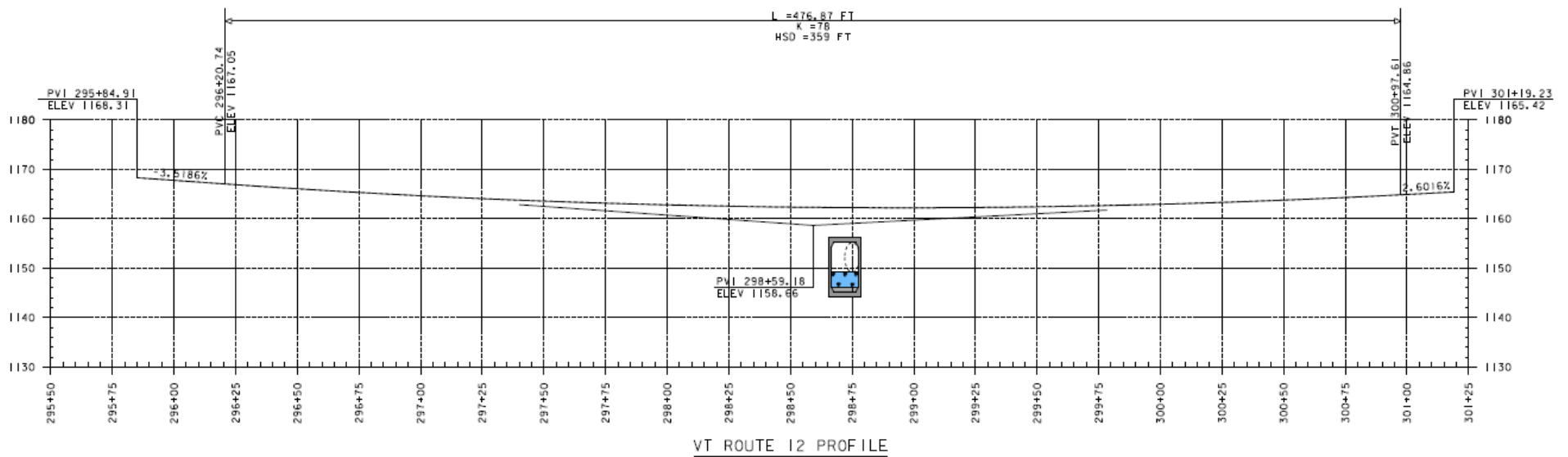

New Bridge - Bridge #94

- Match existing vertical grade

Maintenance of Traffic Options Considered

- Offsite Detour
- Phased Construction
- Temporary Bridge

Selected Method of Traffic Maintenance



Temporary Bridge

- One Lane Temporary Bridge constructed on Downstream side of VT Route 12

Downstream Temporary Bridge Layout

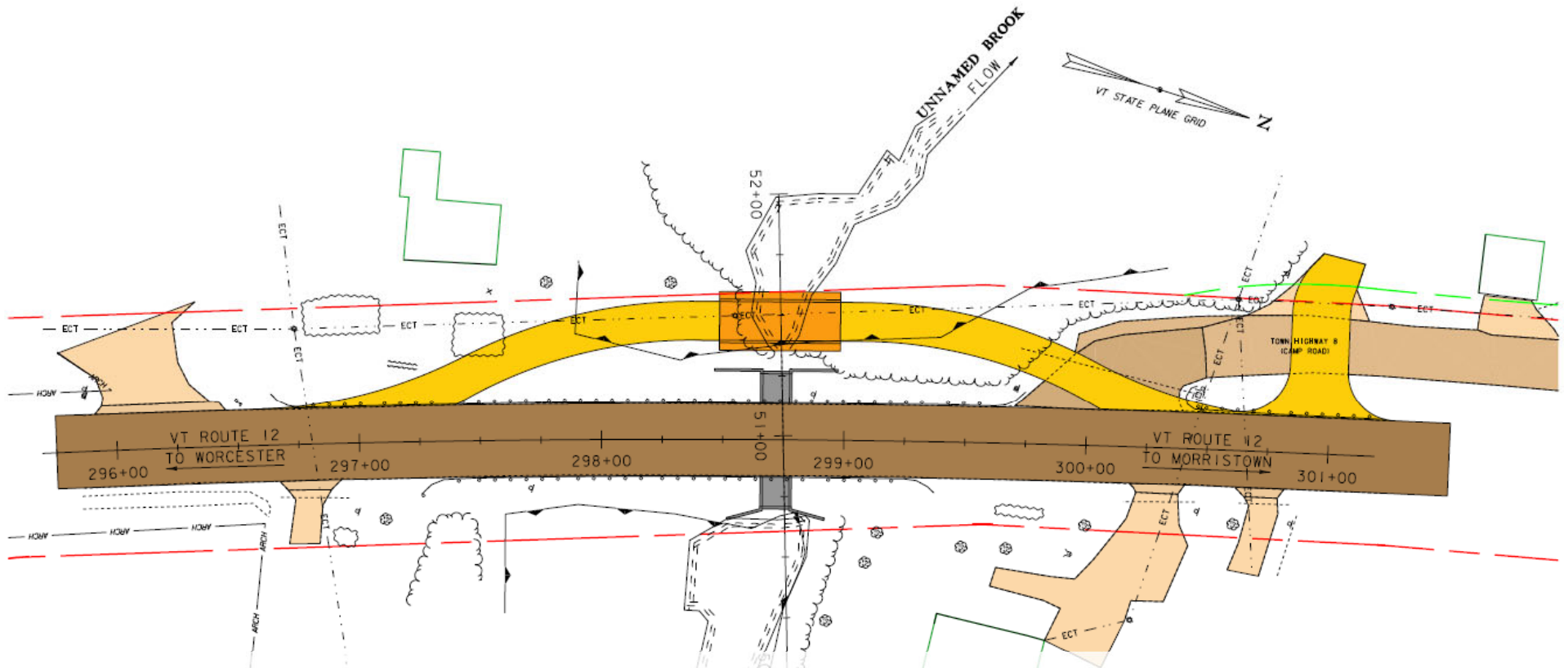

Downstream Temporary Bridge

- Aerial utilities located on downstream side
- Camp Road intersection impacts
- Wetland area impacted
- More State-Owned Right-of-Way on downstream side

Project Summary: Bridge 94

- Culvert Replacement with a New Buried Structure with Traffic Maintained on a Temporary Bridge
 - Precast Concrete Box
 - Contingent on borings
 - 11' x 10' box with Type E4 Stone
 - 11' x 6' waterway opening
 - 75' Culvert Length
 - 11'¼' typical to match existing conditions
 - Exceeds the 11'⅓' standard typical section
 - 75-year design life
 - Right of Way needed

Preliminary Project Schedule

- Construction Start – Summer 2024
 - Total Cost Estimate: \$1,600,000

For more information:

- <https://outside.vermont.gov/agency/vtrans/external/Projects/Structures/19B212>



Elmore BF 0241(55) Questions and Comments VT Route 12– Bridge #94 over Unnamed Brook



Worcester,
Bridge 89



Elmore,
Bridge 90



Worcester,
Bridge 84



Elmore,
Bridge 94



Worcester,
Bridge 87

WE12 - Worcester Elmore VT Route 12 Questions and Comments

VT Route 12 – Elmore Bridges #90 & 94

February 10, 2021